

Dial Calipers

Rugged construction – High accuracy – Patented shockproof design – Ideal for use in the workshop.

Models TESA CCMA-M

Easy-to-read dial calipers – Slider with metal dial housing – Models with a 200 or 300 measuring span fitted with a thumb roller.



DIN 862 (Style 1AR)

$\leq 100 \text{ mm} = 20 \mu\text{m}$
 $> 100 \text{ mm} = 30 \mu\text{m}$

Hardened stainless steel

32 mm diameter rotating dial with lock

Slider with locking screw

Steel gear mechanism, hardened and ground

Patented shockproof design

Suited plastic case

Identification number

Inspection report with a declaration of conformity

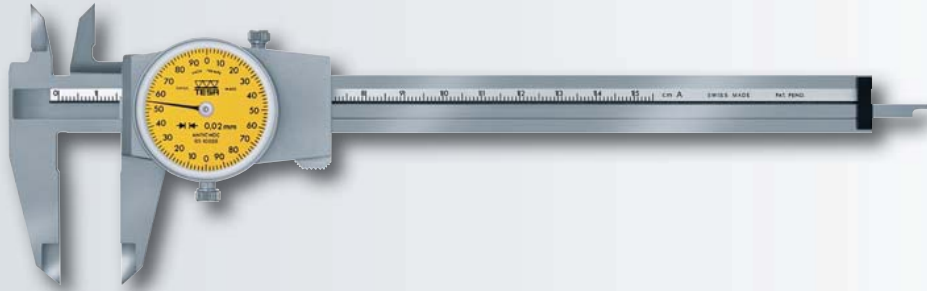

SALCAS

www.SALCAS.com.br

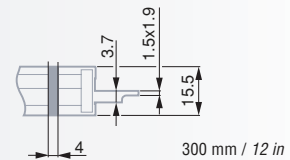
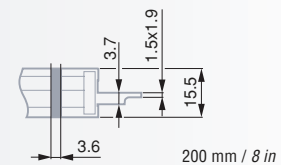
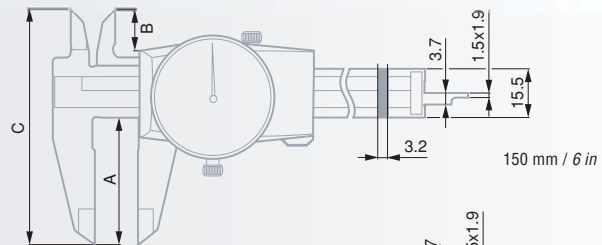
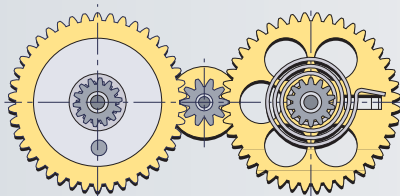

						A mm	B mm	C mm
00510008	0 ÷ 150 mm	0,02 mm	2 mm	–	–	40	13	74
00520002	0 ÷ 6 in	0.001 in	0.1 in	–	–	40	13	74
00510045	0 ÷ 200 mm	0,02 mm	2 mm	●	●	50	18,6	89,5
00510046	0 ÷ 300 mm	0,02 mm	2 mm	●	●	64	20,6	105,5
<i>Optional Accessory</i>								
00560013	Depth foot for models 150 mm/6 in (also see page B-24)							

Model ETALON 125

Slider with metal dial housing – 1 mm per pointer revolution.

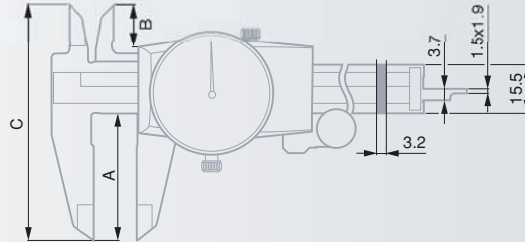
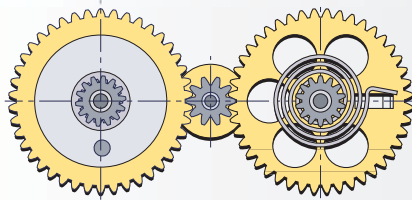

075115821



0 ÷ 150 mm



0,02 mm



1 mm



without thumb roller

Optional Accessory

00560013

Depth foot (also see page B-24)

Model TESA CCMA-M, 0,01 mm

Slider with metal dial housing – 1 mm per pointer revolution.

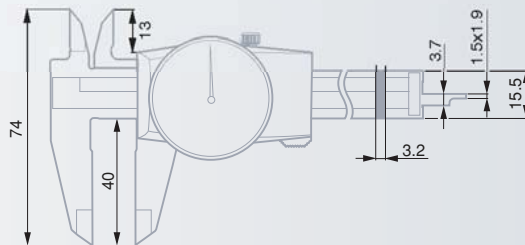
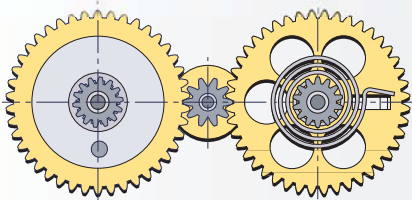

00510050



0 ÷ 150 mm



0,01 mm



1 mm

Optional Accessory

00560013

Depth foot (also see page B-24)



DIN 862 (Style 1AR)



≤ 100 mm = 20 μm
> 100 mm = 30 μm



Hardened stainless steel



32 mm diameter rotating dial with lock



Slider with locking screw



Steel gear mechanism, hardened and ground



Patented shockproof design



Suited plastic case



Identification number



Inspection report with a declaration of conformity



DIN 862 (Style 1AR)



≤ 100 mm = 20 μm
> 100 mm = 30 μm



Hardened stainless steel



32 mm dia. rotating dial with lock



Slider with locking screw



Steel gear, hardened and ground



Patented shockproof design



Suited plastic case



Identification number



Inspection report with a declaration of conformity